

**MAGIC LINE**

**ELECTRONIC  
VACUUM BAG  
SEALER**

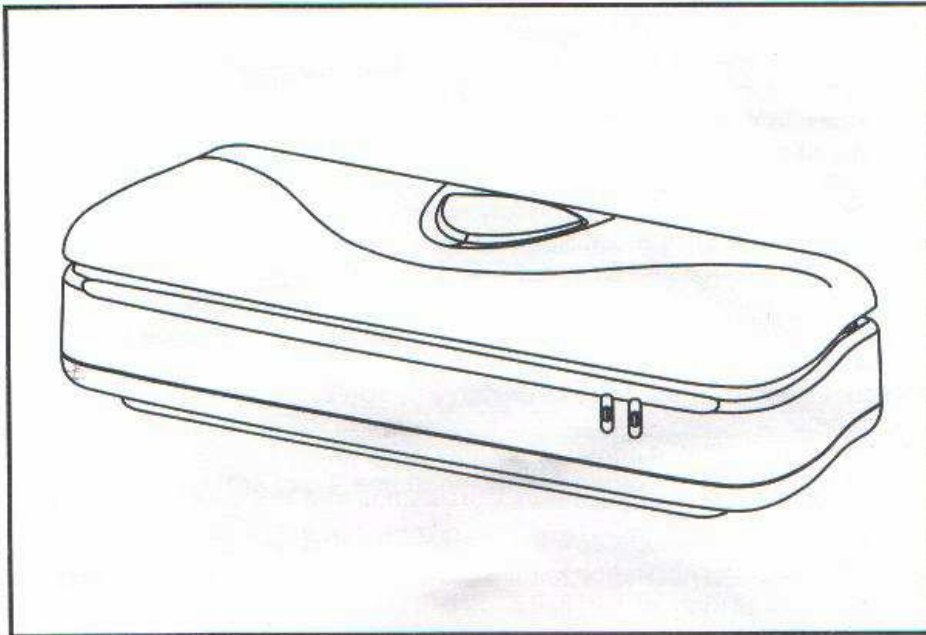

**INSTRUCTIONS FOR USE AND CARE**

**MODEL VBS - 540A**

# USER INSTRUCTIONS

Please keep these instructions

Please read these instructions carefully and familiarise yourself with your new Magic Line Vacuum Bag Sealer before using for the first time.

## 1. RATING

- 230-240V~50Hz 100W
- Ensure that the voltage indicated on the identification plate corresponds with the mains voltage.

## IMPORTANT SAFEGUARDS

When using electrical appliances, basic safety precautions should always be followed including the following:

- **READ ALL INSTRUCTIONS**
- Never use the appliance if it is damaged in any way.
- An appliance should never be left unattended.
- To protect against electrical shock, do not immerse cord, plugs, or appliances in water or other liquid.
- Close supervision is necessary when any appliance is used by or near children.
- Unplug from outlet when not in use and before cleaning. Allow to cool before putting on or taking off parts.
- This appliance should not be used outdoors or placed on or near a hot gas or electric burner, or in a heated oven.
- Do not operate any appliance with a damaged cord or plug or after the appliance malfunctions, or has been damaged in any manner. Return appliance to the factory for examination, repair or adjustment. See warranty.
- Do not plug the appliance into an outlet where another high wattage appliance is being used at the same time.
- The use of accessory attachments not recommended by the appliance manufacturer may cause injuries.
- Do not let cord hang over the edge of the table or counter, or touch hot surfaces, place on a firm flat surface.
- Always unplug the appliance immediately after use.
- Do not use this appliance for other than intended use. This appliance is for household use only.
- For cleaning purposes, please follow the cleaning instructions of this manual.
- When you hand over the appliance to third parties, please make sure you also hand over the users instructional manual with it.
- No liability can be accepted for any damaged caused by noncompliance with these instructions or any other improper use or mishandling.

## SAVE THESE INSTRUCTIONS

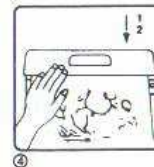
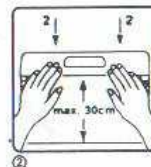
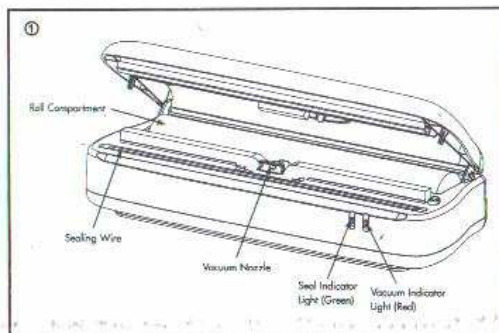

## Operating Your vacuum sealer

### To make a bag :

1. Place the unit on a firm, level surface near an electrical outlet.
2. Insert the roll of bagging material in the roll compartment in the sealer.
3. Plug into an AC230-240V electrical outlet.
4. **When starting a new roll**, remove the sticker from the outside of the roll. Pull the bagging material 1 inch past the sealing wire. Close the lid. **NOTE:** The roll is folded into a double layer.
5. Close the lid and press down equally on both the left and right sides of the lid. Both indicator lights will light up. In about 6 seconds the green "Seal" indicator light will go out and the seal is complete.
6. Lift the lid and tear off the excess bagging material.  
**NOTE:** When closing the lid and applying pressure, two distinct clicks will be heard. These are the switches which operate the two functions of the bag sealer.
7. After the roll is started, pull the bagging material to the desired bag width and seal/cut by closing the lid and pressing down on both sides of the lid.  
**NOTE:** The first side of the bag will be sealed from the previous seal.
8. When the green "seal" light goes out, peel the finished bag off the wire, ensuring no bagging material adheres to the sealing wire. Now you have a bag sealed on three sides ready to be filled and vacuum sealed.  
**NOTE:** The bottom of the bag is where the white label strip is.

### Sealing a filled bag without vacuum action:

1. Make sure food or liquid remains in the top portion of the bag where the seal will be made. This may interfere with the effectiveness of the seal.
2. Place the open end of the bag over the sealing wire, making sure that the bagging material is flat, with no creases along the line of the seal.
3. Close the lid and press down on both sides of the lid, until the green "Seal" light goes out.  
**NOTE:** Remove the bag from the wire immediately after the green "Seal" light goes off. If the bag starts to cool it may stick to the wire and create a hole in the seal when pulled off the wire.

### Vacuum sealing:

1. Place the item to be stored inside the bag. Do not fill completely. Allow a margin of 2 to 3 inches between the item and the open end of the bag. Make sure that the sealing area is free from liquid or food particles. Place the open end of the bag over the sealing wire and insert the vacuum nozzle completely inside the bag.  
**Note:** The bottom layer of the bag should be under the nozzle and the top layer of the bag should be over the nozzle.
2. Close the lid and press lightly with your left hand on the left side of the lid to activate the vacuum motor. Only the red "Vacuum" light will illuminate. The air will be extracted from the bag. **DO NOT** press down on the middle or right side of the lid, this will block the flow of air.
3. When the air extraction is complete, continue to press the left side of the lid and press your right hand down firmly on the right side of the lid. A second click will be heard and the green "Seal" indicator will light up. When the "Seal" light goes out, the bag is sealed.  
**NOTE:** It is not advisable to extract air from bags containing liquid. The liquid can easily be drawn into the working mechanism and cause damage.

## **General Storage**

Protect valuable documents such as insurance policies.

Preserve preserved photographs.

Keep matches, maps and other items safe and dry when boating, on picnics or camping.

Seal cosmetics, lotions, etc., against spills in cosmetic cases, travel bags and suitcases.

Also wrap shoes separately to protect clothing.

Preserve newspaper articles.

Protect rare and valuable books.

Prevent silverware from tarnishing.

Keep seeds and bulbs safe and dry for planting next year.

Distribute party favors.

Organize the kids' toys and crayons.

Keep dice and other game pieces from being lost.

Organize hardware items ...screws, nails, nuts and bolts, etc.

Protect baseball card and stamp collections.

Pack bandages and other first-aid items for travel.

Seal and freeze ice for use in coolers and as cold compress for bumps, aches and pains.

Protect small items of clothing against moth infestation.

Protect jewelry and family heirlooms.

Keep computer disks dust free.

Store and organize countless items around the home such as paper clips, rubber bands and sewing items, etc.

## **ATTENTION**

Appliance not for continuous use. approved for one operating cycle per two minutes  
(approx. 13sec on /90 sec off)

## **CLEANING**

Clean the appliance with a damp cloth only. Let it completely dry before use.

**Note: keep this instruction manual for future reference.**

This appliance is not intended for use by persons (including children) with reduced physical, sensory or mental capabilities, or lack of experience and knowledge, unless they have been given supervision or instruction concerning use of the appliance by a person responsible for their safety. Children should be supervised to ensure that they do not play with the appliance.

If the supply cord is damaged, it must be replaced by the manufacturer or its service agent or a similarly qualified person in order to avoid a hazard.